

DIN 125 Arandela
Washer

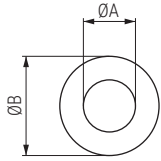

ØA	ØB		Zincado		Acero inox
			Zinc plated		Stainless steel
			CÓDIGO CODE		CÓDIGO CODE
4	9	1.000	861.83	1.000	9006.35
5	10	1.000	861.82	1.000	9006.36
6	12	1.000	861.43	1.000	9006.37
7	14	1.000	861.44		
8	16	500	861.45	500	9006.38
10	20	450	861.46	500	9006.39
12	24	500	861.47	200	9006.40

DIN 9021 Arandela
Washer

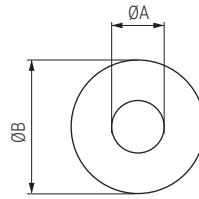

ØA	ØB		Zincado		Acero inox
			Zinc plated		Stainless steel
			CÓDIGO CODE		CÓDIGO CODE
4	12	2.000	861.32	1.000	9006.96
5	15	2.000	861.33	500	9006.116
6	18	1.000	861.34	1.000	9006.117
7	22	1.000	861.42		
8	25	250	861.35	500	9006.84
10	30	200	861.36	200	9006.118
12	40	300	861.37	200	9006.120

Estándar Arandela
Washer

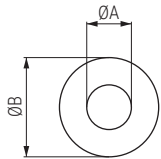

Código Code	ØA	ØB	Material	Acabado Finish	
861.57	7	16	acero/steel	zincado/zinc	500
861.58	8	18	acero/steel	zincado/zinc	500
861.60	10	22,5	acero/steel	zincado/zinc	1.000
861.61	12	22	acero/steel	zincado/zinc	500

AFT Arandela
Washer



Código Code	Ø	Material	Acabado Finish	
365.2	6	acero/steel	zincado negro/black zinc	1.000
365.3	8	acero/steel	zincado negro/black zinc	1.000
365.272	10,5	acero/steel	zincado negro/black zinc	1.000

Grower DIN 127 Arandela
Washer

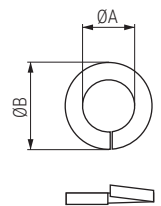

ØA	ØB		ZINCADO		Acero inox
			ZINC		Stainless steel
			CÓDIGO CODE		CÓDIGO CODE
6	11	1.000	361.32	1.000	9006.113
8	14	1.000	361.33	1.000	9006.114
10	17	600	361.34	100	9006.75

DIN 6797-J MIKALOR Arandela dentada
Washer

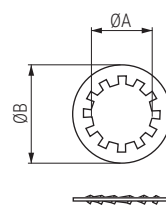

Código Code	ØA	ØB	Material	Acabado Finish	
365.308	6,4	11	acero/steel	zincado negro/black zinc	2.500
365.309	8,2	15	acero/steel	zincado/zinc	1.000
365.310	10,5	18	acero/steel	zincado/zinc	1.000
365.311V	13	20,5	acero/steel	zincado/zinc	500